

RoHS
Compatible

△				
△				
△				
△				
ZONE	REV	DESCRIPTION	DATE	APPD.

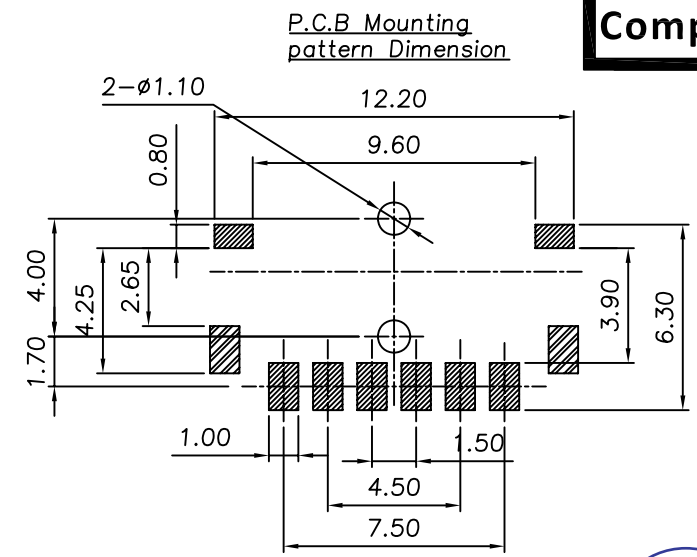
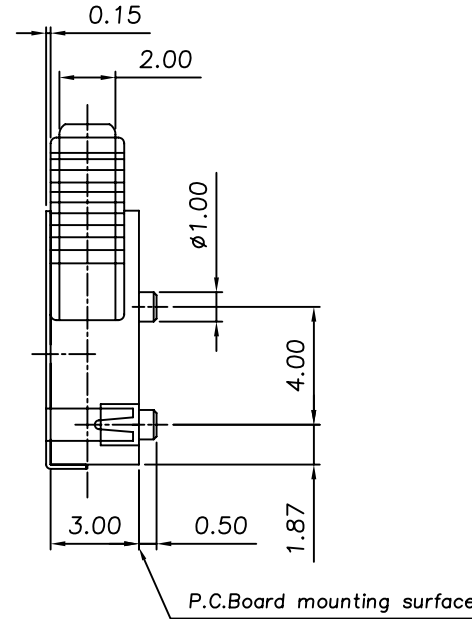
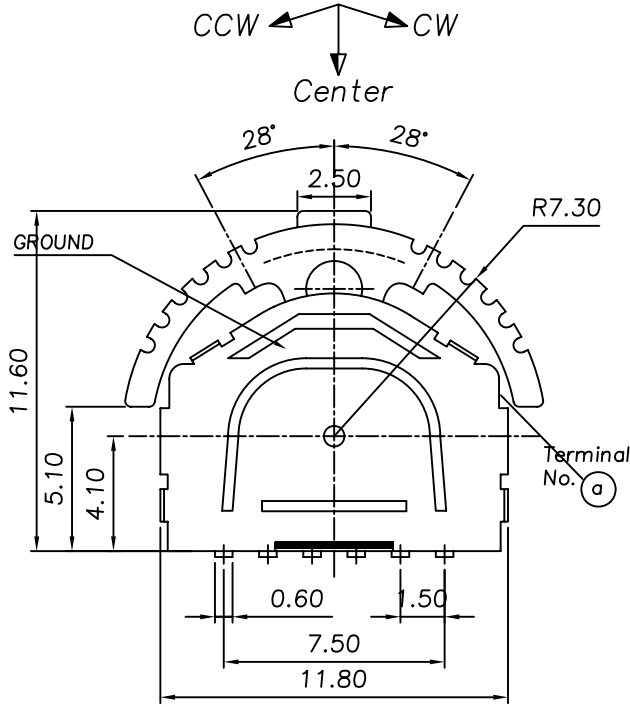

Specification
 1. Rating : 10mA 12V DC
 2. Operating force :
 80±50gf (lever portion)
 205±100gf (push portion)
 3. Operating life : 100,000 cycles Min.

發行
2012.10.30
達立

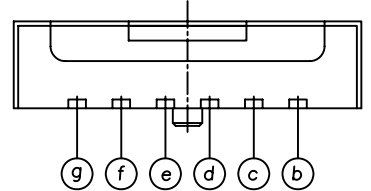

Circuit Diagram :
 (a) CCW ← Contact (b) (c) (d)
 (a) CW → Contact (f) (g)
 (a) Center ↓ Contact (e)

6	Spring	Stainless Steel	1	Natural
5	Clip	Phosphor Bronze	1	Ag Plated
4	Cover	Stainless	1	Ag Plated
3	Lever	Nylon	1	Black
2	Terminal	Brass	1	Ag Plated
1	Case	Nylon	1	Black
No.	Part Name	Material	Q'ty	Finishing

達立科技股份有限公司
Dawning Precision Co., Ltd.
 TEL: 886-2-82271388 FAX: 886-2-82272198

DESIGN	Will	SCALE		
DRAWING	Will	UNIT	mm	
CHECK	Will	SIZE	A4: 210*297	
APPROVAL	Eric	VERSION	01	

TOLERANCE UNLESS OTHERWISE STATED(mm)	PART NAME	PUSH & LEVER SWITCH
less than 10 — ±0.2	PART NO	K01-S097
10~30 — ±0.3	DRAWING NO	
30~100 — ±0.5	DATE	2012/10/30
ANGIE — ±2°		